

## IPONG® TRAINER MOTION OPERATIONS MANUAL USER GUIDE



A. Core Engine - 1 	B. Agitator - 1 	C. A/C Adapter - 1 	D. Top/Bottom Assembly - 2 
E. Wireless Remote - 1 	F. Tilt Stand - 1 	G. 1-Star ABS Ball - 80 	H. Ball Pickup Net - 1 

### QUICK START ASSEMBLY INSTRUCTIONS

1. Remove all contents from the box.
2. Attach the Agitator (B) to the top of the Core Engine (A) by aligning the plastic rod on the Core Engine (A) to the hole on the bottom of the Agitator (B) and pressing down until secure.
3. Align the tabs on the Bottom Assembly (D) to the slots at the bottom of the Core Engine (A). Insert and turn clockwise to lock.
4. Align the tabs on the Top Assembly (D) to the slots at the top of the Core Engine (A). Insert and turn clockwise to lock.
5. Before plugging into the electric outlet, insert the A/C Adapter (C) into the back of the Core Engine (A).

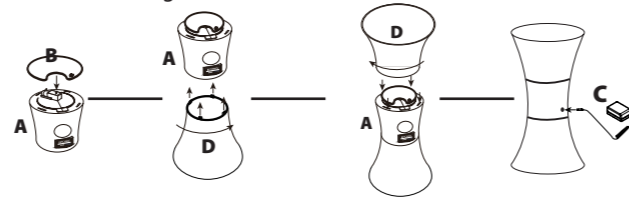

### NOTE: iPong should only be used with 40mm table tennis balls.

1. Place the assembled iPong™ on the table, close to the back end and along the middle line. Then, angle the projection hole to the desired left or right position on the table.
2. Before turning on the iPong, make sure that there are no table tennis balls inside the core engine. Rotate the agitator manually so that the round gap in the agitator is not lined up with the ball entry hole. This will reduce the possibility of jamming.
3. Dispense table tennis balls into the top assembly. 60-100 table tennis balls is the recommended amount.
4. Press the power button and play/pause button immediately after. This gives you time to adjust each setting on the remote to your preferences. Then, press the play/pause button to start playing. Review the instructions below on how to customize your settings.

### Settings Customization

The iPong™ uses an upper wheel and lower wheel to control ball spin, speed, and trajectory. When the upper wheel spins faster than the lower wheel, topspin is generated. When the lower wheel spins faster than the upper wheel, backspin is generated. When both wheels are spinning at the same speed, the ball is traveling across the table with no spin.

#### Topspin Ball

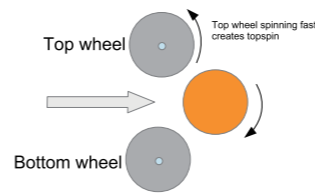

#### Backspin Ball

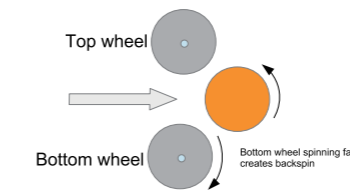

Caption: Note: Due to varying conditions (ball size, dust, humidity, altitude, etc.), the remote control settings provided for the iPong may not be exact. Adjust these settings to meet your desired need.

### Accessorize your iPong



#### Ball Catch Net

- Collects balls during serve, multi-ball, or robot practice
- Additional side netting for increased coverage
- Durable with steel frame and 100% polyester net



#### iPong Balls

- 100 orange training balls
- Reusable box with convenient carrying straps



#### Ball Pickup Net

- Rubber, ergonomic grip and collapsable pole handle with extension feature that twist locks into place
- New net shape for larger ball capacity



Visit [www.ipong.net](http://www.ipong.net)

### Settings Overview

Start with the iPong in pause mode . Using the plus buttons and minus buttons , adjust each setting accordingly. For example: Frequency: "1" and Oscillation: "0". (See below for Topspin and Backspin settings.) Then press play/pause button to start .

**Beginner topspin:** This setup will create a slow topspin ball which is ideal for beginning players. First set the robot 12" inward from the back edge of the table. Then set Topspin: "2" and Backspin: "1".

**Topspin Settings:** First set the iPong at back edge of table. Then set Topspin: "3" and Backspin: "1". For a stronger topspin, and increased distance, change these settings from 3:1 to 4:1, 5:1, 6:1, 7:1 or 8:1. If balls are going off the table, decrease the Topspin setting accordingly.

**Backspin Settings:** First set the iPong at back edge of table. Then set Topspin: "0" and Backspin: "6". For a stronger backspin, and increased distance, change the settings from 0:6 to 0:7 or 0:8. If balls are going off the table, decrease the Backspin setting accordingly.

### Frequency Settings

Frequency is the rate at which table tennis balls shoot out of the iPong. The higher the Frequency setting, the greater the number of balls shoot out per minute. "1" is the lowest frequency while "8" is the highest frequency.

### Oscillation (Side-To-Side) Settings

Oscillation is the setting used for shooting balls to random locations on the table. The higher the Oscillation setting, the faster the iPong side-to-side motion. "1" is the slowest oscillation while "8" is the fastest oscillation.

### The Memory Function

The iPong™ has the ability to save your favorite settings.

When you have your favorite settings turned on the iPong™, press the pause button on the remote, followed by pressing the memory button.

When you want to recall your saved setting, make sure you're in play mode and press the memory button. You'll notice that the iPong™ changes to your saved settings.

To change your saved settings, repeat steps 1 and 2 above.

### iPong Maintenance

- After each use of the iPong, we suggest you remove the power adaptor.

Clean the balls used in the iPong after several uses. (Balls will collect dust on the surface, and this might affect the function of the iPong).

Wipe the iPong after several uses, and put it back into the box (or a bag) to avoid collecting dust.

Clean the wheels of iPong often! This is an important step in maintaining this product. Wet a clean cloth with water, or alcohol, and wipe the wheels a few times by running the cloth along the surface of the wheel.

Clean the motor under the agitator. First, disassemble the horn, then pull the agitator straight up lightly, to remove the agitator. You will see dust or hair around the motor. Carefully remove with a clean cloth.

The iPong Tilt Stand is a multi-tiered iPong elevation tool, designed to change ball trajectory and increase shot variation. Three heights are available: 9mm, 17mm, or 26mm. The tilt stand is especially useful when setting the iPong to shoot slow balls, or fast backspin balls - that otherwise might NOT go over the net. A bit of experimentation will be required. With the tilt stand on the front of the iPong, go up in elevation if balls go into the net. And go down in elevation if balls go off the table.

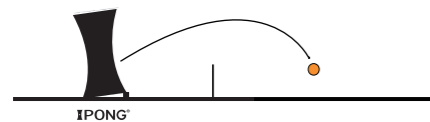
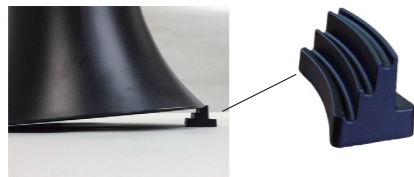

For **slower** balls, position iPong near center of table. Start with tilt stand in lowest position, and adjust upward as needed.

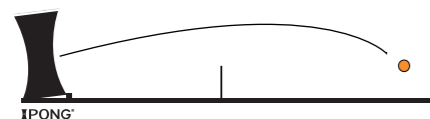

For **fast backspin** balls, position iPong near end of table. Start with tilt stand in highest position, and adjust downward as needed.

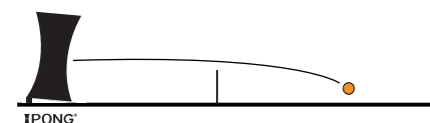

**Advanced:** Place tilt stand on **rear** of iPong. Use for **very fast topspin** balls. Position iPong near end of table - OR in middle of table! Start in lowest position, and adjust upward as needed.

An iPong Target set is available for FREE if you complete the steps outlined on the card included in the box. The iPong Target set include 3 targets: Small, Medium, and Large. Below are several games which can be played using these targets.

**A. One, Two, Three.**

Place the large target in the left corner of the table. The medium target in the middle (on the centerline). And the smallest target on the far right hand corner of the table. Turn on the iPong and aim for the large target first. Once you hit this one, then aim for the medium target. And then finally aim for the small target on the far right. This game is fun and will improve your accuracy in controlling the horizontal placement of your shots.

**B. The Tower**

Stack the three targets on top of each other, with the largest target on the bottom. The medium-sized target in the middle. And the small target on top. This target 'Tower' can be placed anywhere on the table. Turn on the iPong and aim for the small target first. Once you hit this one, then aim for the medium target. And then finally aim for the large target on the bottom. This game is fun and will improve your accuracy in controlling vertical placement of your shots.

**C. Speed Pong**

For this game you will set the frequency of the iPong to it's maximum. The the targets can be placed anywhere on the table. Turn on the iPong, and see how quickly you can knock down each of the targets. This game is fun and will improve your hand-eye speed.

Another variation of the above game can be played with another player, by using a timer to count how long it took each of you to knock down the three targets. Quickest time wins.

Be sure to visit our website at [www.ipong.net](http://www.ipong.net) and register your iPong robot when you purchase it to activate your warranty. If you experience a usage issue with your unit, you can go through our list of common issues and their solutions below. If your problem persists, please fill out the support form on our website [www.ipong.net](http://www.ipong.net).

**Having trouble with Topspin/Backspin settings?**

- Remember that when the Topspin and Backspin settings are the same, no spin is generated on the ball.
- Check the Settings Customization in the beginning of the user guide.

**iPong won't turn on?**

- Check to see that the A/C adapter is plugged in all the way.

**Core engine not running?**

- Check to see that the A/C adapter is plugged in all the way.
- Unplug A/C adapter. Take the agitator off to see if there are obstructions (dust, hair, pet dander, etc.) keeping the motor from spinning. Remove any obstructions, re-plug A/C adapter and try again.

**Rubber wheels not spinning?**

- Check to see that the A/C adapter is plugged in all the way.
- Unplug A/C adapter. Remove top and bottom assembly. Remove front plastic casing by pressing the top and bottom tabs. Check to see if there are any obstructions (dust, hair, pet dander, etc.) keeping the rubber wheels from spinning. Remove any obstructions, re-plug A/C adapter and try again.

**Balls hitting the side of the projection hole?**

- Be sure you are using the correct sized balls. iPong robots work only with 40mm table tennis balls, and work best with plastic table tennis balls.

**Balls falling out of projection hole, not shooting?**

- Be sure you are using the correct sized balls. iPong robots work only with 40mm table tennis balls, and work best with plastic table tennis balls.

**Balls shooting out at different angles?**

- Be sure you are using the correct sized balls. iPong robots work only with 40mm table tennis balls, and work best with plastic table tennis balls.

**Balls not shooting at a consistent speed?**

- Check to see that the A/C adapter is plugged in all the way.

**Balls shooting off the end of the table?**

- Be sure you are using the correct sized balls. iPong robots work only with 40mm table tennis balls, and work best with plastic table tennis balls.
- Try moving the iPong further back, closer to the edge of the table.
- Decrease the Backspin setting and/or increase the Topspin setting incrementally and test until the balls start hitting the table again.

**Balls are loaded but agitator is not moving?**

- Remove some of the balls from the top assembly. Overloading the top with balls may be too heavy for the agitator to rotate.

**Balls getting jammed?**

- Be sure you are using the correct sized balls. iPong robots work only with 40mm table tennis balls, and work best with plastic table tennis balls.
- The maximum ball capacity of the top assembly is 100 balls. 60-100 table tennis balls is the recommended amount.
- If the round gap on the agitator stops directly above the ball entry hole, multiple balls could enter into the core engine at once and stall. To prevent this, avoid turning the iPong off with the ball entry hole and agitator gap aligned.

**Balls getting jammed immediately after reloading?**

- This is often caused by the Topspin and/or Backspin settings starting at "0" when first turning on the iPong. Turn off the iPong and remove all balls from the core engine and top assembly. Let the iPong run empty, making sure that the Topspin and Backspin settings are set to "1" or higher. Then, reload the balls while the iPong is running.

LIMITED FACTORY WARRANTY

**A ball is jammed or stuck inside the iPong?**

- Unplug the iPong. Manually reach in and fish the ball out. You can also tip the unit upside down and shake it gently to get the ball to fall out.

**Agitator tab broken?**

- The agitator is a sensitive part and can break if the iPong is not handled carefully. Once the agitator is broken, it cannot be fixed manually. Contact customer service for a replacement part.

**Core engine is very loud?**

- Power off the iPong and examine for any obstructions in the wheel motors. Also, check that iPong is on a level surface to prevent the motors from vibrating and moving around.

**Last few balls in the top assembly aren't shooting out?**

- This is an indicator that it is time to reload the balls.

**Does the iPong require any maintenance?**

- It does not require any maintenance, although it is important to make sure the wheels are clean and free from dust, hair, and pet dander.

**Balls lying around on the floor?**

- Try our Table Tennis Ball Catch Net or Table Tennis Ball Pickup Net to make collecting balls faster and easier. Available at [www.ipong.net](http://www.ipong.net) under Accessories.

If your problem or question isn't helped by any of these suggestions please fill out the support request form at [ipong.net](http://ipong.net)

JOOLA North America, LLC ("JOOLA") warrants iPong Table Tennis Robots are free from defects in workmanship and materials under normal personal use and conditions for a period of one year from the date of original purchase in the United States and Canada.

**iPong Registration**

Registration must be completed within 10 days from the date of your purchase of the iPong Table Tennis Robot. You can access the registration from online at the [ipong.net](http://ipong.net) website and submit your information electronically.

**What is Covered**

Except as provided below, the Limited Warranty covers all defects in materials and workmanship.

This Limited Warranty is void if the iPong Table Tennis Robot is:

- damaged through improper usage, negligence, misuse, abuse, transportation damage, acts of nature, or accident (including failure to follow the instructions supplied with the iPong Table Tennis Robot)
- used in commercial applications or rentals
- modified by anyone not authorized by the Company

If during the Limited Factory Warranty period, any part or component of the iPong Table Tennis Robot is found by JOOLA to be defective, JOOLA will, at its discretion, repair the unit, offer a replacement unit (either the same or an equivalent model), allow the original retailer of the unit to exchange the defective unit with a new unit (either the same or an equivalent model), or refund the original purchase price of the unit, without charge for labor or parts. JOOLA's obligation to repair, replace, or exchange the unit, however, is limited to the amount of the original purchase price of the iPong Table Tennis Robot.

**How to Obtain Warranty Service**

In order to obtain warranty service under this Limited Warranty, please follow the following steps:

- User must complete and submit the iPong Table Tennis Robot Registration within 10 days of purchase.

- Retain the original copy of the sales receipt.

- Call JOOLA's Customer Service Department at (301) 816-3060 anytime from 9:00 am to 5:00 pm (EST) to notify JOOLA of the nature of the problem and to find out how to obtain servicing. JOOLA will decide whether the iPong Table Tennis Robot may be serviced at user's location or at a location designated by JOOLA.

- If instructed to return the iPong Table Tennis Robot to JOOLA for servicing, user is responsible for shipping the unit, at his/her own expense, to the address provided by JOOLA in adequate packaging that will protect it against further damage.

- Include owner's name, address, daytime telephone number, model number of iPong Table Tennis Robot, and a description of the problem.

- JOOLA will pay for any shipping charges to return the repaired or replaced iPong Table Tennis Robot.

**THIS LIMITED WARRANTY IS AVAILABLE ONLY TO THE ORIGINAL PURCHASER OF THE IPONG TABLE TENNIS ROBOT AND IS VALID IN THE UNITED STATES AND CANADA ONLY.**

**JOOLA'S LIABILITY IS LIMITED TO THE REPAIR OR REPLACEMENT, AT ITS DISCRETION, LF ANY DEFECTIVE IPONG TABLE TENNIS ROBOT AND DOES NOT INCLUDE ANY LIABILITY FOR INDIRECT, INCIDENTAL OR CONSEQUENTIAL DAMAGES OF ANY KIND.**

**THIS WARRANTY IS EXPRESSLY MADE IN LIEU OF ALL OTHER WARRANTIES, EXPRESSED OR IMPLIED.**

This Limited Warranty gives you specific legal rights, but you may also have other rights that vary from state to state.

For questions regarding this Limited Warranty or the IPONG TABLE TENNIS ROBOT, please write us:

iPong Customer Service Department  
2101 Gaither Road, Suite 125  
Rockville, MD 20850

[www.ipong.net](http://www.ipong.net)

**Reordering Parts**

Please contact JOOLA North America, LLC via the online support from and have the following information ready:

- Original Product number
- Part Number (from assembling instructions)
- Serial Number (from back of robot)
- Credit card information (number, expiration date, CVC code, billing name and address ) for payment processing (if after warranty)
- Shipping address for replacement parts

iPong Customer Service Department •  
2101 Gaither Road, Suite 125 • Rockville, MD 20850