

**OWNER'S
MANUAL**

MODEL NOS.

T8503



Thank you for buying our product. We try hard to ensure that our products are of high quality and free of problems, such as manufacturing defects or missing parts. However, if you have any problems with your new product, please **DO NOT RETURN IT TO THE STORE!**

DO NOT RETURN THIS PRODUCT TO THE STORE!

Call us at:

TOLL FREE 1-866-873-3528
(THIS IS A CONSUMER ONLY NUMBER)
Please have this Owner's Manual with you when you call.

Or write us at: CUSTOMER SERVICE DEPT., P.O. Box 889, Evansville, IN 47706
Fax Number: (812) 467-1399.

Or E-mail us at: customerservice@escaladesports.com

Please provide model number and/or part number (not just the key number) of the product and/or part when you call or write. These numbers can be found on the product, packaging, and/or in this Owner's Manual.



**READ THESE
INSTRUCTIONS
CAREFULLY!**

Tools Needed: ■ Two 7/16 Open \ Boxed End Wrenches ■ Two 1/2 Wrenches
■ Tape Measure ■ Two 9/16 Open \ Boxed End Wrenches

Hardware Identifier

(NOTE: This hardware shown actual size. For specific information, see Product Parts List on back.)

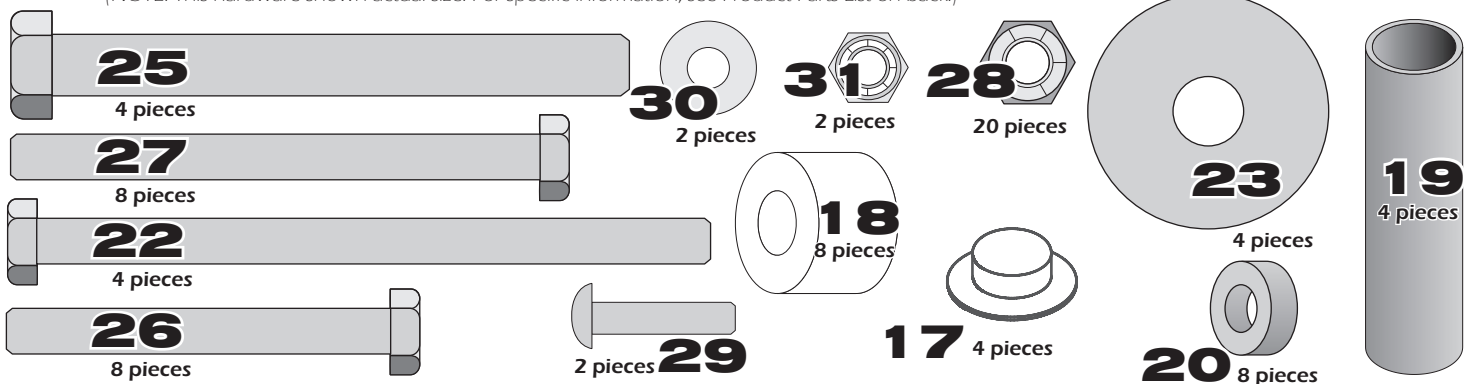

1. ATTACHING LEGS TO TABLE TOPS



CAUTION

AT LEAST TWO ADULTS ARE NEEDED TO COMPLETE THE FOLLOWING STEPS!

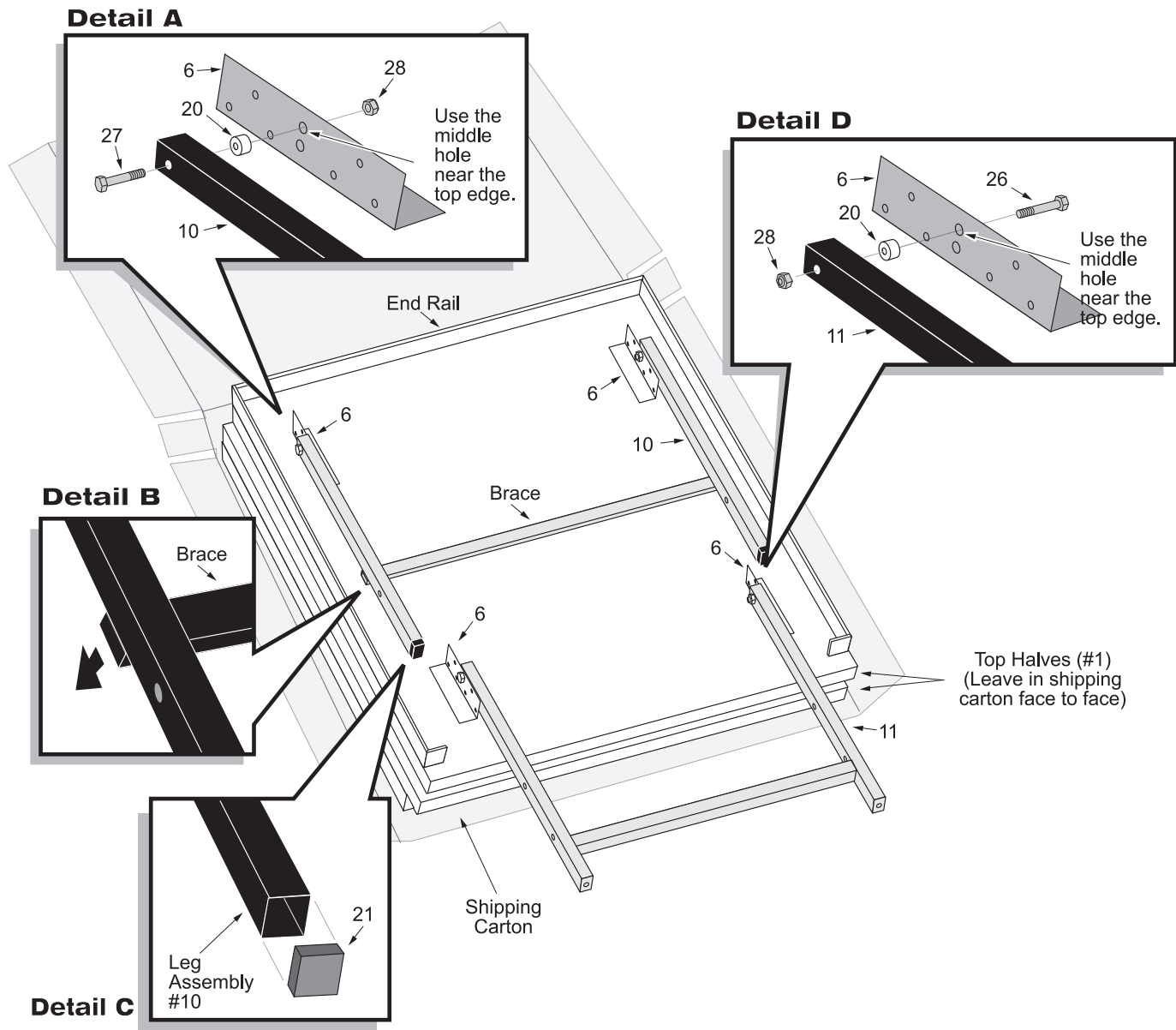

1. Leave top halves #1 in shipping carton as shown above or lay them on a carpeted floor (*to protect them from damage and scratches*).
2. Attach leg assembly #10 to brackets #6 located on the bottom of the first top half #1. (See above). Use bolts #27, spacers #20 and locknuts #28. (See Detail A).
NOTE: Be sure brace on leg assembly #10 is against table. (See Detail B).
Tighten these locknuts snug but **DO NOT OVERTIGHTEN THEM. JOINT MUST MOVE!**
3. Put caps #21 on bottom end of leg assembly #10. (See Detail C).

4. Attach upright assembly #11 to remaining brackets #6 on the bottom of the first top half #1. (See above). Use bolts #26, spacers #20, and locknuts #28. (See Detail D). Tighten locknuts snug but **DO NOT OVERTIGHTEN THEM. JOINT MUST MOVE!**
5. **With a helper**, set the first top half #1 on its side against a wall. (*Be sure to put a piece of cardboard, cloth, or carpeting on the floor first to protect the top's edges.*) Turn the second top half #1 over and repeat steps 2-4 to assemble it.

2. ATTACHING NAME PANELS TO LEGS



CAUTION

AT LEAST TWO ADULTS ARE NEEDED TO COMPLETE THE FOLLOWING STEPS! DO NOT LEAVE TABLE UNATTENDED UNTIL ASSEMBLY IS COMPLETE!

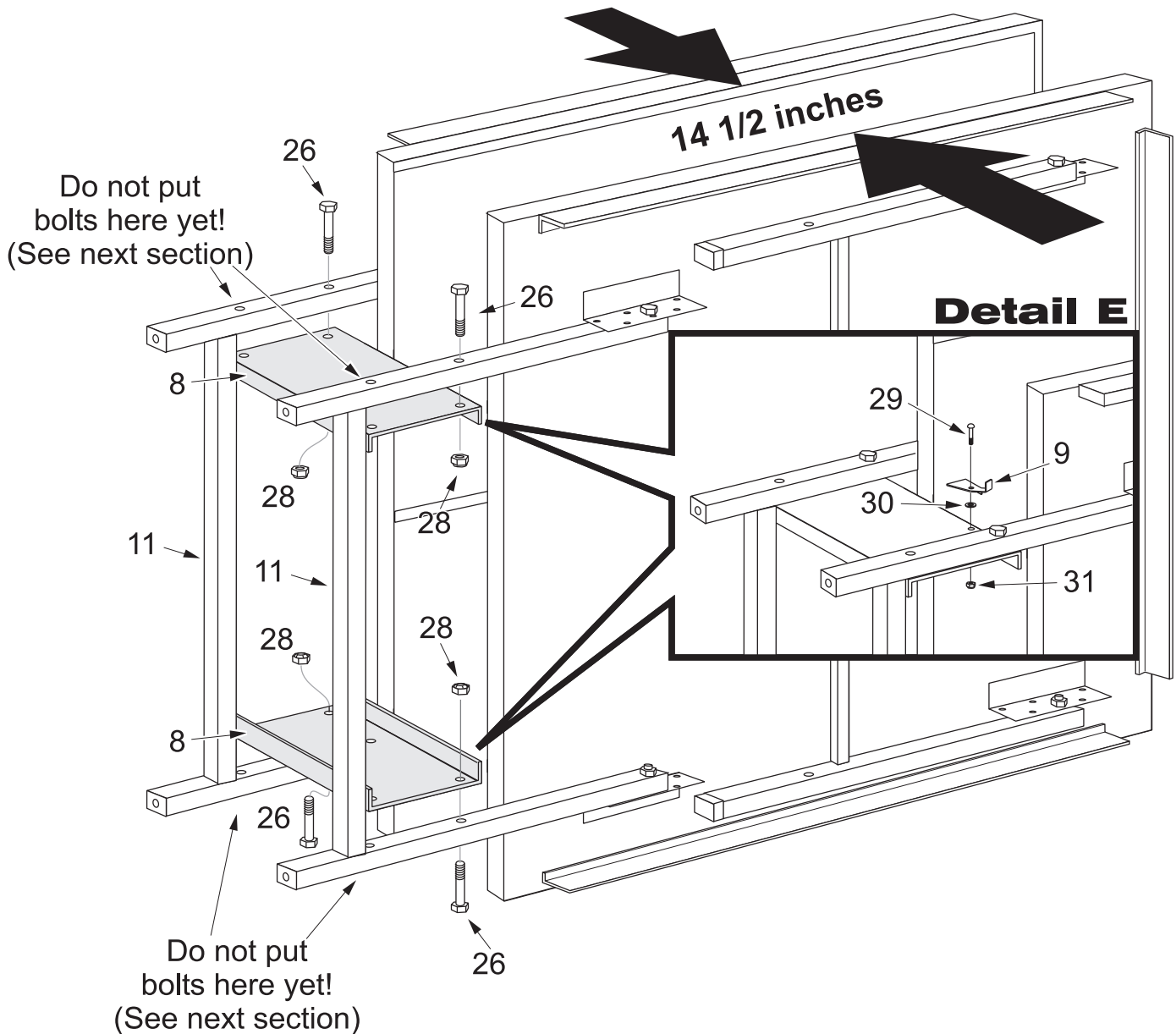

- 6. With a helper, hold top halves about 14 ½ inches apart.** Attach only **one half** of name panels #8 to upright assemblies #11 as shown above. Use **ONLY TWO** bolts #26 and locknuts #28 on each name panel.

(Two other bolts #27 and nuts #28 will be used in the next section to attach the other half of the name panels and linkages #24 at the same time. See next page.) **Do not tighten these locknuts completely tight yet.**

HELPFUL HINT: Start at the bottom and insert two bolts #26 **UPWARD** through upright

assemblies #11 and name panel #8. Then attach the upper name panel #8. Insert bolts #26 **DOWNWARD**.

- 7. Attach safety latches #9 to name panels using one screw #29, flat washer #30 and locknut #31. (See Detail E). Attach a safety latch to one name panel to hold one table half and the other safety latch to the other name panel to hold the other table half. Do not overtighten locknuts. Latches must pivot freely. When latch is pivoted it must fall back to original position when released.**

3. ATTACHING LINKAGE TO LEGS

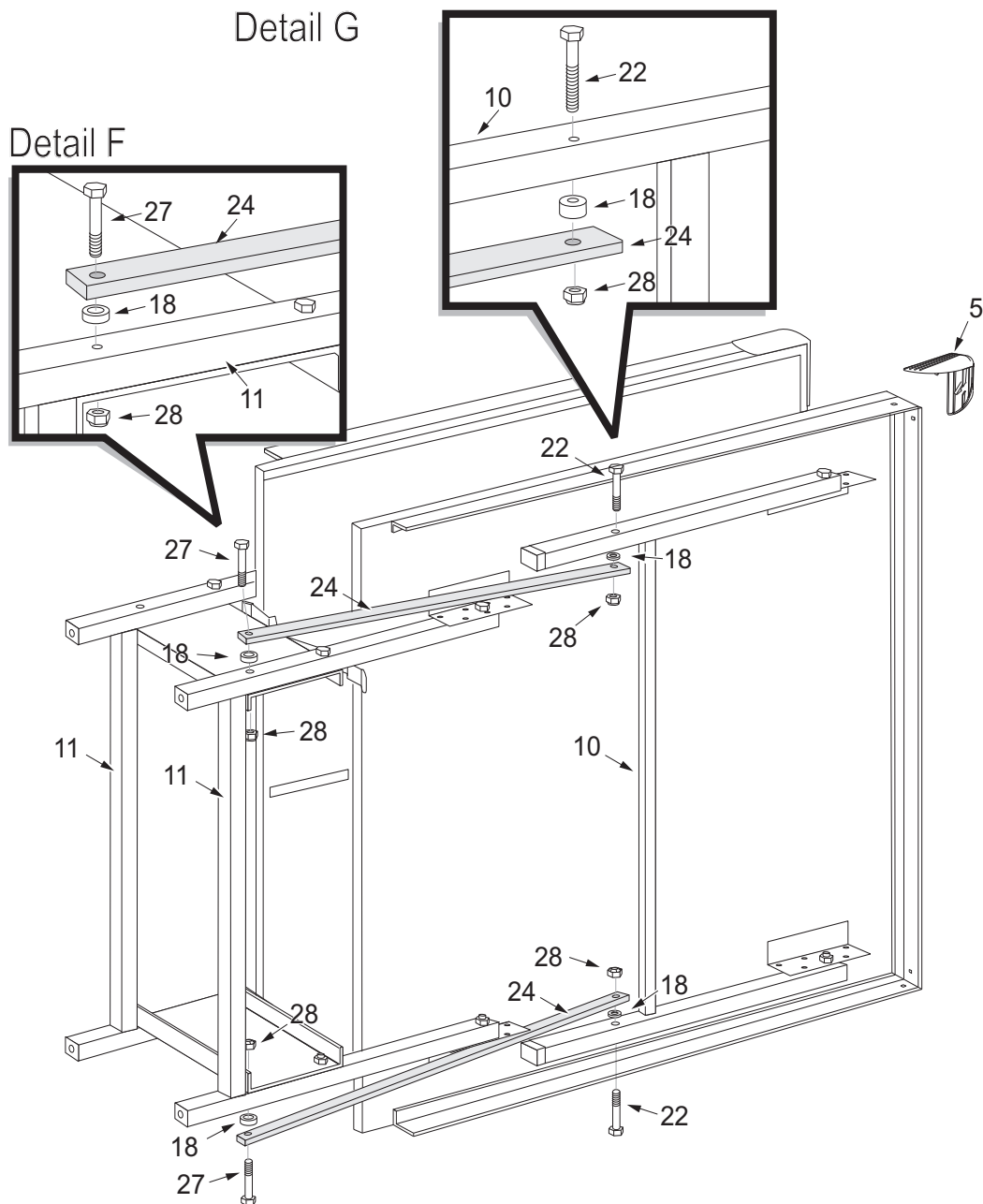

8. Attach linkages #24 to upright assembly #11 using bolts #27, spacers #18, and locknuts #28. (See Detail F).

NOTE: TIGHTEN LOCKNUTS SNUG, BUT DO NOT OVERTIGHTEN. JOINTS MUST BE ABLE TO MOVE!

NOTE: If you have trouble inserting bolts #27 through name panels #8, slightly loosen bolts #26 (that you used in the previous section to attach name panels #8). (See Section 2 on previous page).

9. Attach other end of linkages #24 to leg assembly #10 using bolts #22, spacers #18, and locknuts #28. (See Detail G). Tighten these locknuts snug, but **DO NOT OVERTIGHTEN THEM. THIS JOINT MUST BE ABLE TO MOVE!**

10. Attach corner protectors #5 to table corners. Push snap tabs on corner protectors into holes in rails.

11. Repeat steps 8 - 11 on other top half #1.

4. ATTACHING CASTERS

12. Put caps #15 into ends of caster beams #12 (see Detail H).

13. Attach one **non-locking** caster #13 and one **locking** caster #14 to each caster beam #12 with push nuts #17. (See Detail H). Note: Use a hammer to tap push nuts onto casters securely.

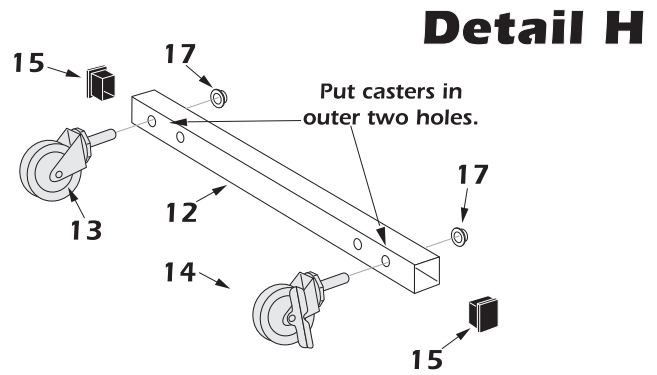

14. Attach caster beams to upright assemblies #11 with bolts #25, washers #23, and spacer bushings #19.

NOTE: Spacer bushings #19 slide **INSIDE** caster beams #12 to keep beams from crushing. (See Detail J). Tighten bolts #25 tight.

15. Lock both locking casters #14. (See Below).

NOTE: Casters should always be locked unless moving table.

Detail J

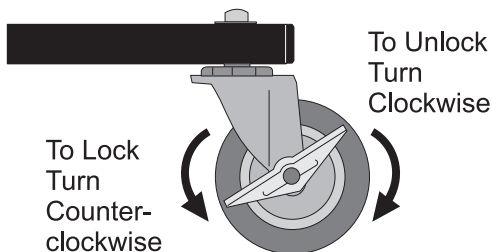
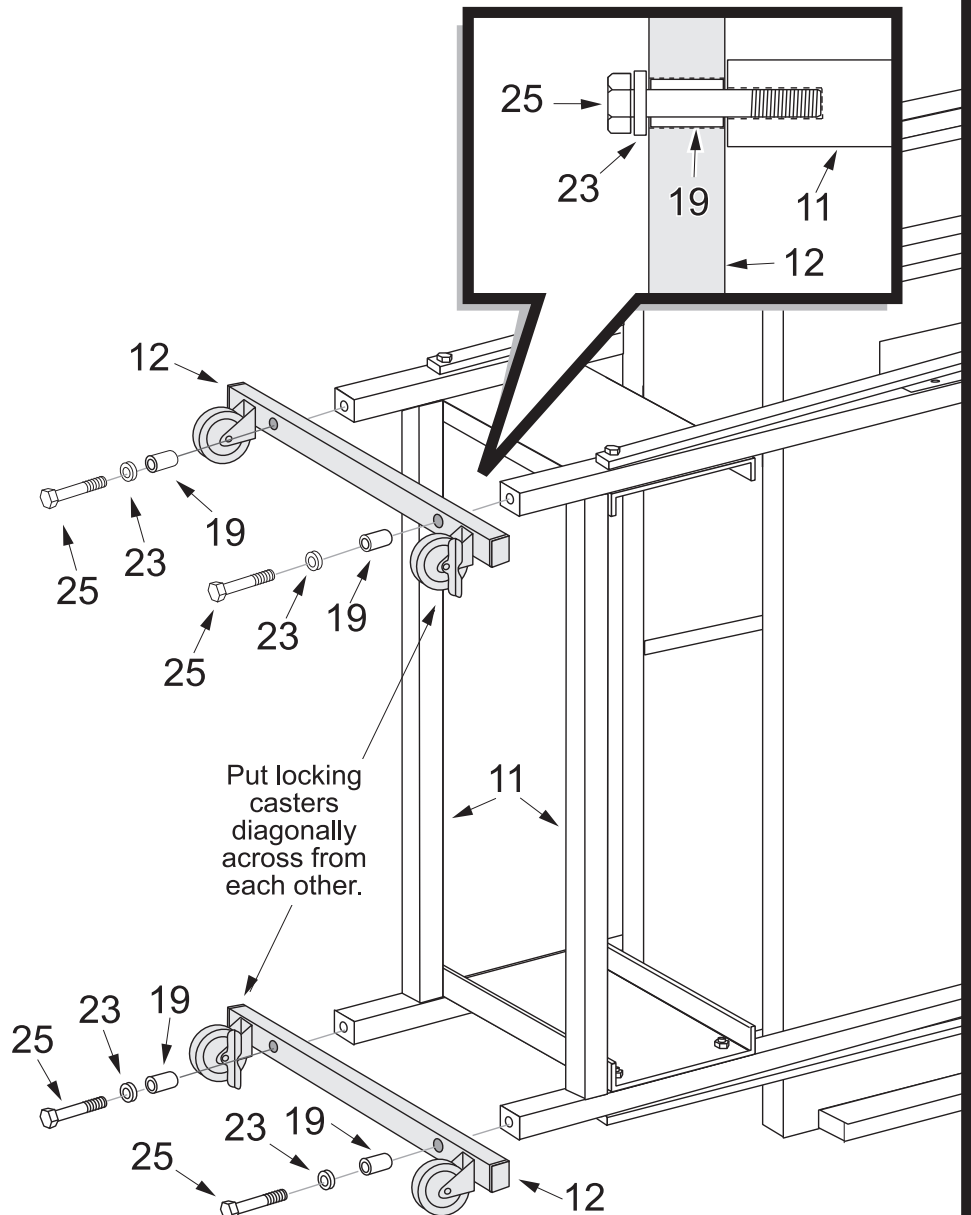

5. SETTING TABLE UPRIGHT



At least two adults are needed to complete the following steps. Be sure top halves are locked in safety latches! Be sure that both locking casters are locked! You must use a 7" stack of magazines (or similar block) to protect the casters when lifting table upright!

Detail K

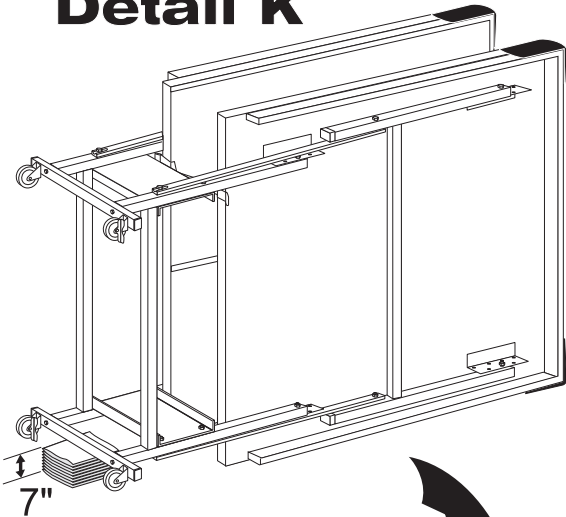

Detail L

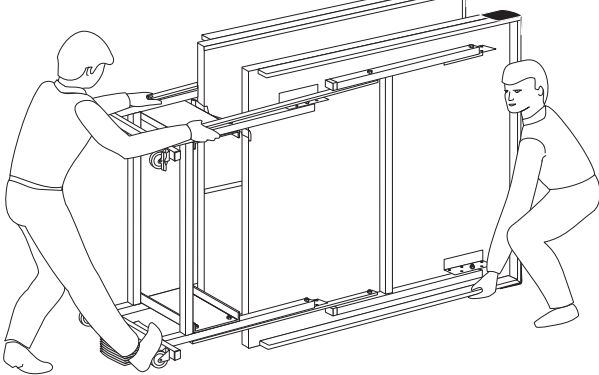

Detail M

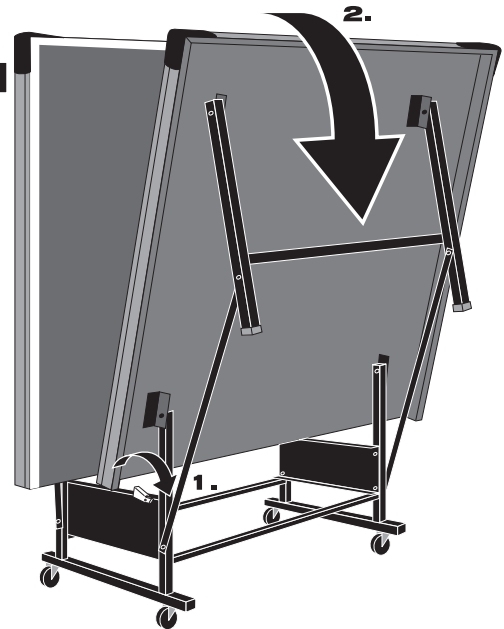

16. Before lifting table, be sure both top halves are locked in safety latches! Be sure casters are locked! Put a 7 inch stack of magazines, wood, etc. under caster beam nearest the floor to protect casters. (See Detail K).
17. With the help of one other adult, brace lower caster beam with your foot and lift table upright. (See Detail L).
18. Once upright, release safety latch and lower table top halves. (See Detail M and **OPERATING INSTRUCTIONS** on next page).

6. MAKING FINAL ADJUSTMENTS

If your gap between table halves is greater than $5/16$ " or uneven adjust it as follows.

19. Loosen the six bolts shown below and adjust table so that the space between the two table top halves measures $5/16$ of an inch.
20. Retighten these bolts.
21. Check over entire assembly to be sure all nuts and bolts are secure. Remember, do not overtighten bolts at joints that move.

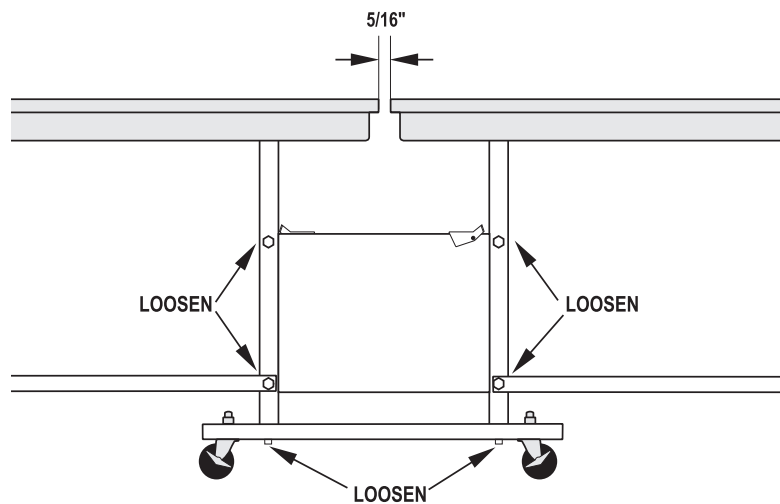

OPERATING INSTRUCTIONS



- ALWAYS LOCK TABLE TOP HALVES IN SAFETY LATCHES WHEN STORING, MOVING, OR USING TABLE IN ITS PLAYBACK POSITION!
- ALWAYS LOCK CASTERS, EXCEPT WHEN MOVING TABLE!
- DO NOT SIT, STAND, WALK OR JUMP ON THIS TABLE!

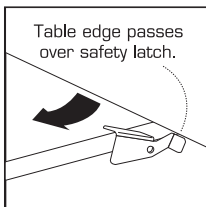
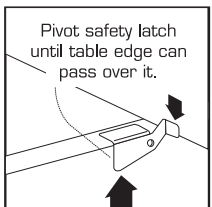

Closed or Storage Position

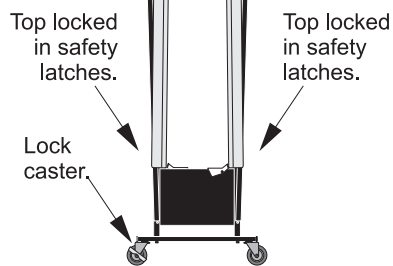

Playback Position

Top locked in safety latches.

Lock caster.

To open table:

1. Lock both locking casters.
2. Release safety latch and pull table top outward and downward. Be ready to support weight of table top. **Table top is heavy**
3. Lower table top half.

To close table:

1. Lock both locking casters.
2. Lift table top half.
3. Check that top is locked in safety latches.

Open or Playing Position

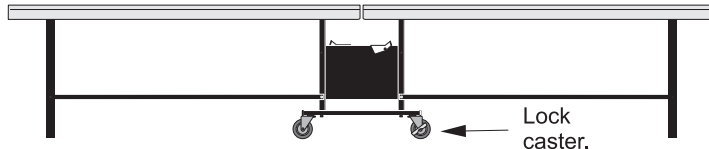

Net System Description

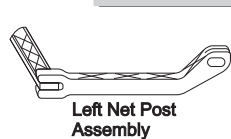
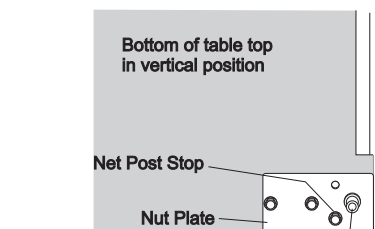

1. Net Post Assembly

Attach plastic net post as shown with washer and knob. Note: there is a left and right net post assembly (See Net System Description). Post assembly should rest flat against nut plate. Slide the net sleeve over the vertical post while the net post assembly is folded in toward the side of the table top. Fold the net post assembly out against the net post stop into the post and secure bead chain in catch.

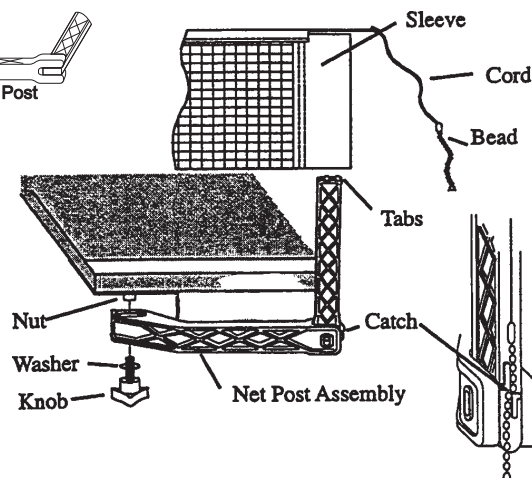

2. Adjustments

A - Adjust overall net tension by slightly loosening the knob and moving net post assembly. Moderately tighten knob. Net post assembly should be kept square with the table by the net post stop (See Net System Description).

B - Adjust tension of cord with bead chain on each side. Assure that chain is fully seated in catch.

C - Position top of net to a regulation height of 6" from the table surface by firmly gripping the vertical net post within height adjustment slot.

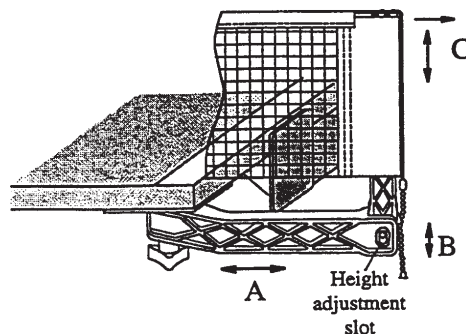

3. Storage

Caution: To prevent damage to the net system and/or table top, the post assembly must be pivoted toward side of table before lifting table tops to storage position.

Loosen knob and pivot net post toward table side as far as it will go. Retighten Knob.

CAUTION

This table must be kept indoors to prevent damage to the playing surface. Dampness and extreme temperature changes which occur on patios, or similar areas, can cause wood to warp, swell, crack or blister.

UNEVEL FLOORS: If your table does not seem level, it is probably because the floor is not level. Move table around several inches to find the best location for the table (first be sure table is in playing position). If floor is extremely unlevel, the table may not play or operate properly. If the table is high in the center, shim up under leg assemblies.

Use PART # column when calling for replacement parts.

T8503 PARTS LIST

QTY. column refers to the total number of pieces in product.

ITEM #	PART #	DESCRIPTION	QTY	ITEM #	PART #	DESCRIPTION	QTY
1	4A-6407-00	Table Top Half	2	18	904-62	Nylon Spacer	8
2	2S-6715-05	Side Rail - Right Hand	2	19	7B-6240-01	Spacer Bushing	4
3	2S-6716-05	Side Rail - Left Hand	2	20	704-104	Spacer	8
4	2S-6714-00	End Rail	2	21	3M-6248-00	Leg Cap	4
5	3M-6715-00	Corner Protector	4	22	701-160	1/4 -20 x 3-1/2 Hex Head Bolt	4
6	2S-6139-01	Mounting Bracket	8	23	901-37	3/8 Heavy Washer	4
7	701-105	#8 x 9/16 Screw	154	24	8S-6504-02	Linkage	4
8	2S-6136-06	Name Panel	2	25	1B-6047-00	5/16-18 x 3 Hex Head Bolt	4
9	2S-6496-02	Safety Latch	2	26	701-82	1/4 -20 x 2 Hex Head Bolt	8
10	1A-6943-01	Leg Assembly	2	27	1B-6191-00	1/4 -20 x 2-3/4 Hex Head Bolt	8
11	1A-7009-01	Upright Assembly	2	28	701-26	1/4 -20 Locknut	20
12	8s-6503-01	Caster Beam	2	29	801-120B	#10 - 24 x 3/4 Phill Hd Screw	2
13	2Q-6459-00	Caster (Non-locking)	2	30	701-1	#10 Burr Washer	2
14	2Q-6460-00	Caster (Locking)	2	31	601-80B	#10 - 24 Locknut	2
15	3M-6248-00	Tube Plug	4	32	5A-6882-00	Net and Post Kit	1
16	2L-7120-00	Owner's Manual	1	33	1A-6285-00	Nut Plate	2
17	601-84	3/8 Push Nut	4	34	3M-6495-00	Paddel Pouch	1

Care and Maintenance: You have purchased a quality product that will give you years of enjoyment. By following these simple steps you will add to the life of your new table.

IMPORTANT NOTE ABOUT TOP: The top (playing surface) of your table is of a special (particle board) construction. Like all wood products it can be affected by atmospheric changes, meaning both temperatures and humidity. This may cause a slight sag, or distortion as the top expands or contracts. This is normal and is no cause for concern as it does not detract from the play or utility value of the table. To minimize this sag, always store table in a dry area, in the folded up position.

Storage for your table: This table must be stored indoors to prevent damage to the playing surface. Dampness and extreme temperature changes can cause the wood to warp, swell, crack, or blister. When your table is not in use, it must be folded up in a dry area.

Cleaning your table: To clean your table use a soft damp **NOT WET** cloth only. To prevent damage to your table's playing surface **DO NOT** use any chemicals, abrasive, or cleaning products on your table's playing surface.

Maintenance for your table: Be sure to oil all moving parts of your table, including pivot points. This will insure the safety and ease of use of your table.

LIMITED 1 YEAR WARRANTY

Manufacturer warrants to the original retail purchaser, this product to be free from defects in material and workmanship for a period of one (1) year from the date of purchase. Should this product become defective due to material or workmanship within the warranty period, contact our Customer Service Department. If defective by the terms of this warranty, we will, at our option, repair or replace the product. This warranty is not transferable and does not cover normal wear and tear, or damage caused by improper handling, installation or use of this product. This warranty is also void if product is in any way abused, damaged, or modified from its original state, or if used for other than residential use. This warranty gives you specific legal rights, and you may have other rights which vary from state to state.

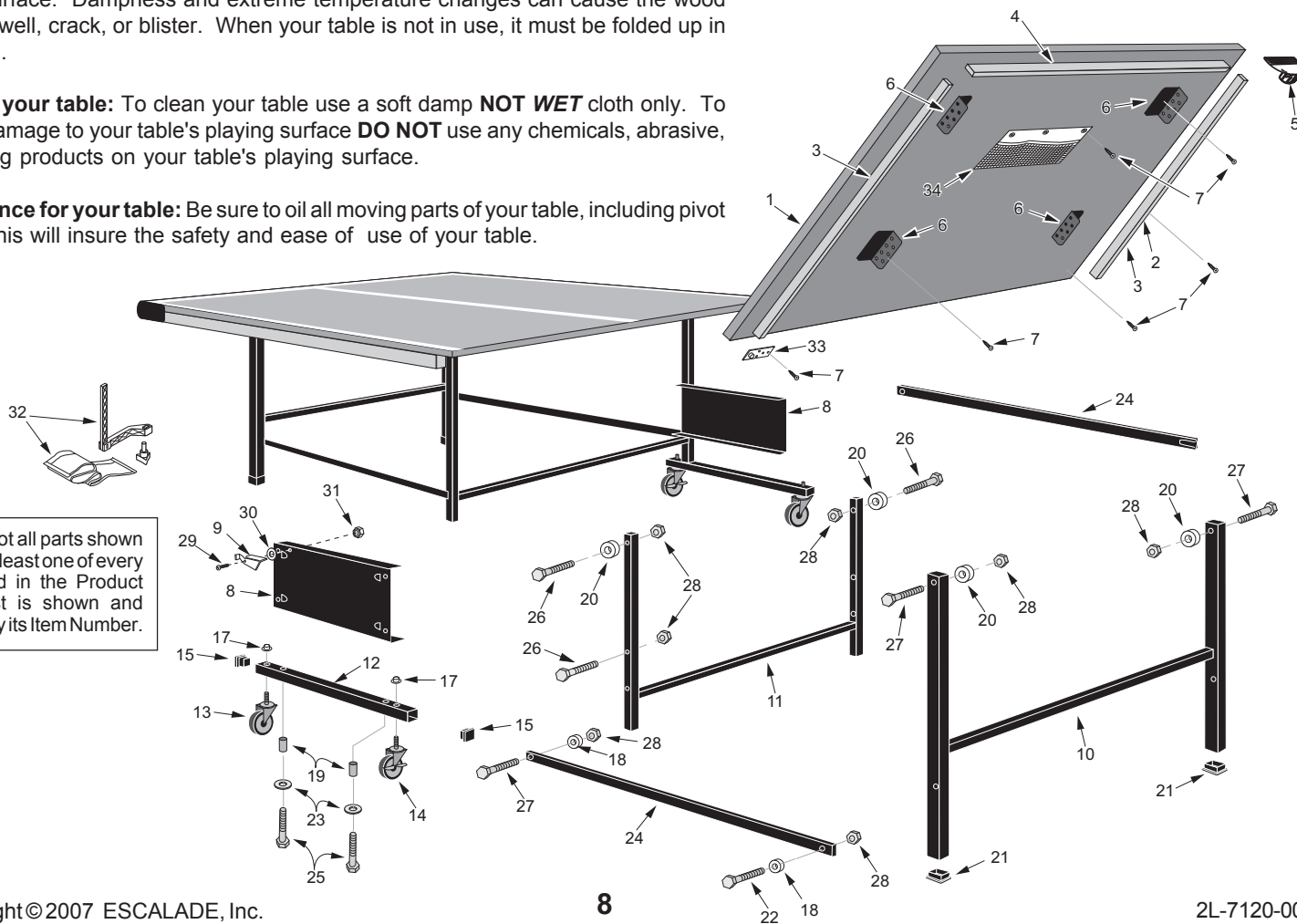

NOTE: Not all parts shown below. At least one of every part listed in the Product Parts List is shown and marked by its Item Number.